

BENCHMARK COORDINATES			
	NORTH	EAST	ELEV
BM1	666,679.899	1,960,693.199	1,296.278
BM2	666,748.087	1,960,673.143	1,296.302
BM3	666,708.600	1,960,703.891	1,296.535
BM4	666,722.780	1,960,741.892	1,287.007
BM5	666,734.48	1,960,783.374	1,294.140
BM6	666,687.763	1,960,671.307	1,295.490

HORIZONTAL COORDINATES OF BENCHMARKS WERE DETERMINED BY DIFFERENTIAL GPS MEASUREMENTS WITH BASE STATION AT BASE POINT. BM1 WAS ASSUMED TO BE AT N=666,679.899 E=1,960,033.199 Z=1,296.278. BEARING WAS DETERMINED BY BACKSIGHTING BM7 FROM BM1 WITH AN AZIMUTH OF 42.36 59'.

1,400
1 cm = 4 m

LEGEND

- PIEZOMETER
- BENCHMARK
- CASING
- SURFACE ARRAY
- STAND PIPE PIEZOMETER
- CROSS-HOLE TEST CASING

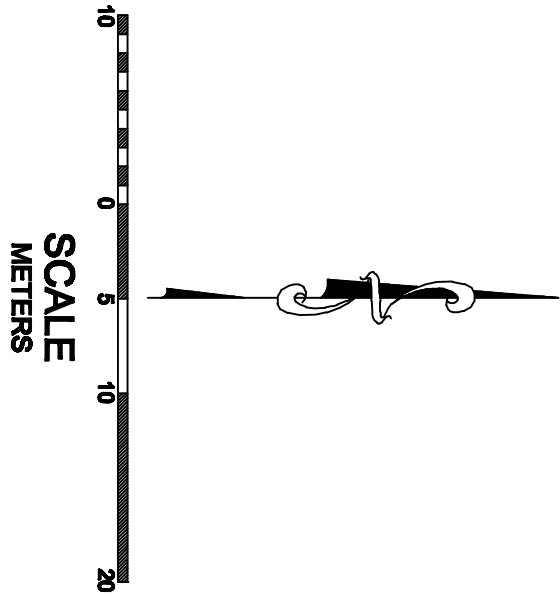
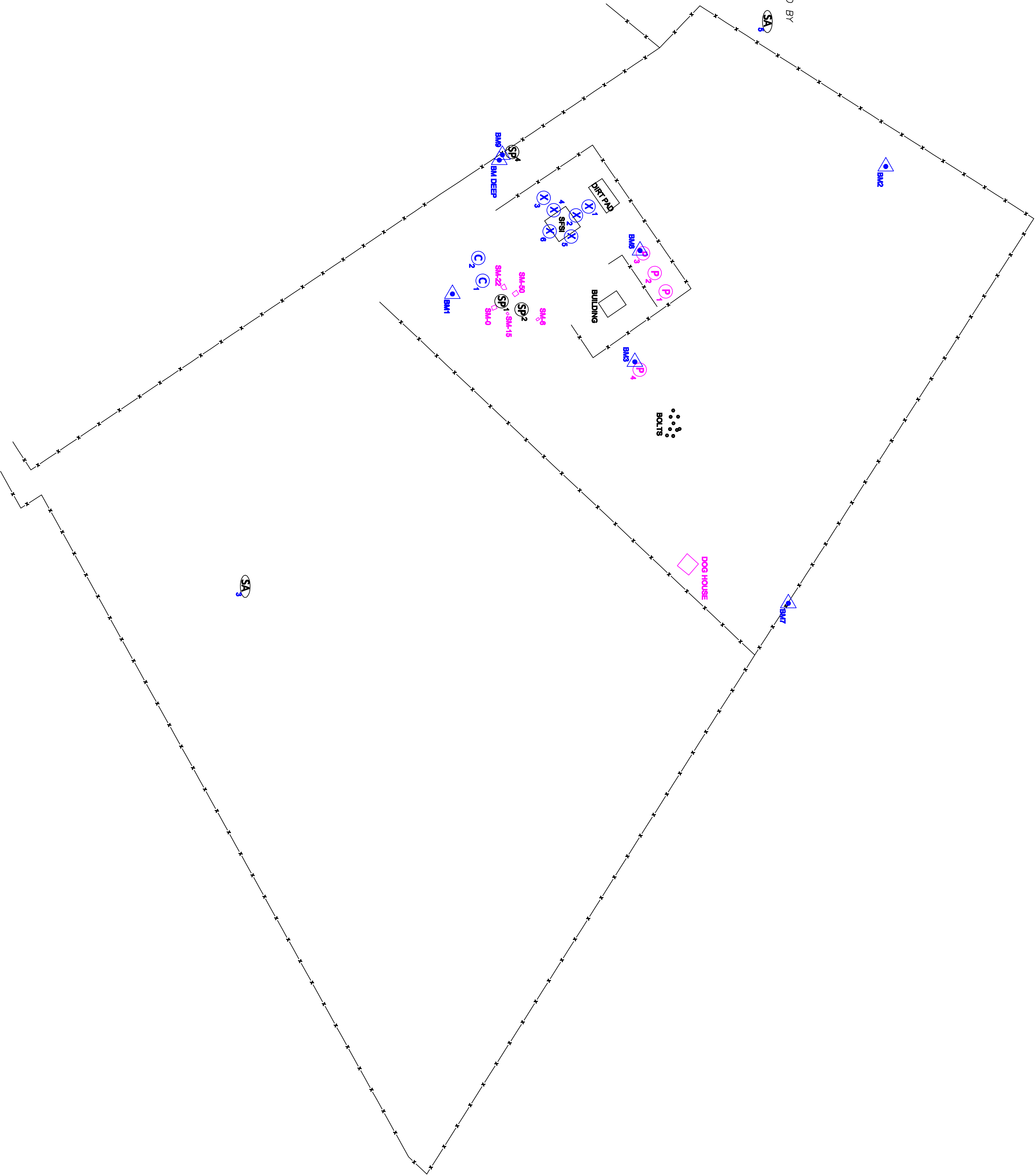

REVISIONS			
NO	DESCRIPTION	DATE	BY

PROJECT NO: 1	DRAWN BY: HDM	PREPARED BY ALEXANDER LOVETT HAROLD MITCHELL PE, PLS	SITE MAP FOR GARNER VALLEY EARQUAKE MONITORING SITE LAKE HEMET, CA	BOSS ENGINEERING & SURVEYING 220 N. 1300 W., SUITE 4, PLEASANT GROVE, UT 84062, (801) 763-8467 FAX (801) 763-8472
DATE: 31 MAY 2011	DESIGNED BY:	FROM FIELD SURVEY APRIL 27, 2011		
SHEET NO.: 1 OF 1	CHECKED BY: HDM			